

# RISHI BANKIM SHILPAUDYAN, NAIHATI

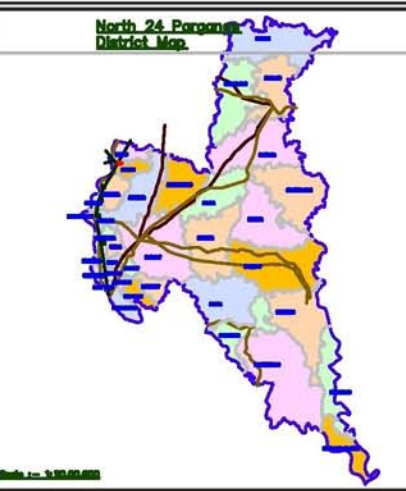
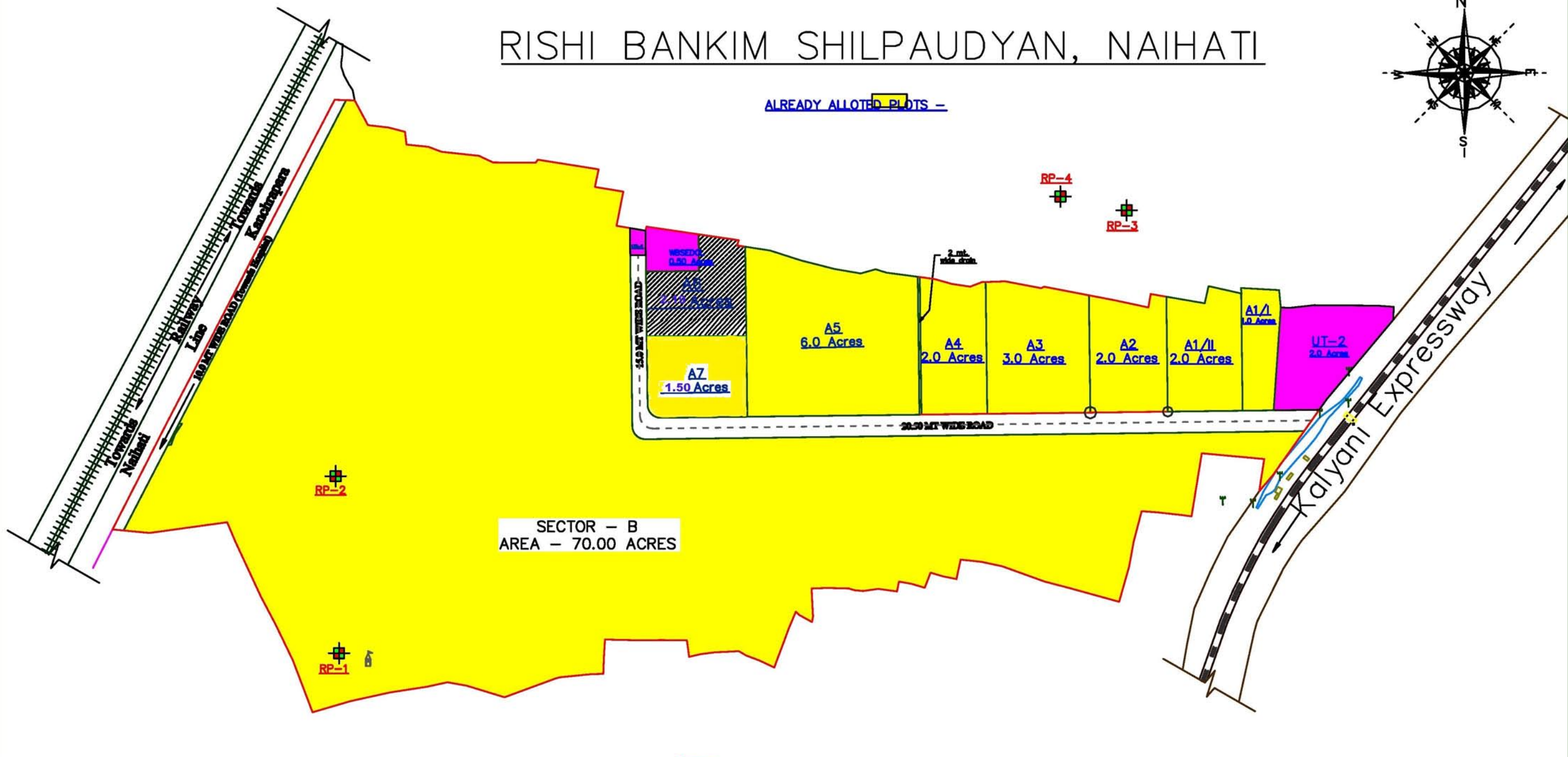
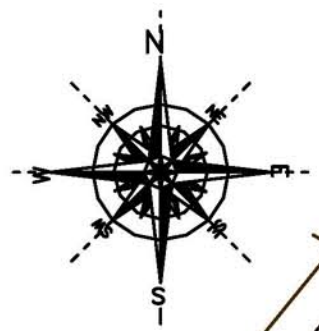

**:- LEGEND :-**

Sl. no.	Description	Symbol
1.	Project Boundary Shown as.	
2.	Mouza Dag lines & No. Shown as.	2473
3.	Reference Pillar Shown as.	
4.	Plots to be Alloted Shown as.	
5.	National Highway Shown as.	
6.	Railway Line Shown as.	
7.	Buildings Shown as.	
8.	Mouza Boundary Shown as.	

**Project:-**  
**MASTER PLAN OF "RISHI BANKIM INDUSTRIAL PARK"**  
**AT P.S. :- NAIHATI & BIZPUR.**  
**DISTRICT :- North 24 PARGANAS, WEST BENGAL.**

**Notes:-**

- All dimensions are in meter.
- List of Reference Pillars :-
  - i) RP-1 :- North: 2533349.005, East: 646585.703, R.L.: 99.979
  - ii) RP-2 :- North: 2533520.045, East: 646582.404, R.L.: 99.793
  - iii) RP-3 :- North: 2533776.908, East: 647346.312, R.L.: 99.834
  - iv) RP-4 :- North: 2533790.202, East: 647282.367, R.L.: 99.794

**Main drawing Reference factor :- 1:3960 or 16"=1 mile**

**Requiring Body**



**WEST BENGAL INDUSTRIAL  
DEVELOPMENT CORPORATION LIMITED**  
 ( A. GOVT. OF WEST BENGAL UNDERTAKING )  
 "PROTITI"  
 23, ABANINDRANATH TAGORE SARANI.